

2017-18





# Fox Faculty Expert Guide

The Fox School of Business at Temple University is home to more than 210 world-renowned faculty and research leaders in their respective fields. They lead innovative undergraduate and graduate programs, conduct cutting-edge research, and can provide insightful, engaging commentary on timely business topics.

## Scheduling an Interview

### CONTACT:

Christopher A. Vito  
Associate Director of Communications  
and Media Relations,  
**215-204-4115**  
**[cvito@temple.edu](mailto:cvito@temple.edu)**

## Table of Contents

Faculty experts are listed by academic department, with their respective areas of expertise listed below.

2	Accounting
4	Finance
6	Human Resource Management
9	Legal Studies in Business
10	Management Information Systems
12	Marketing & Supply Chain Management
16	Risk, Insurance & Healthcare Management
19	Statistical Science
20	Strategic Management

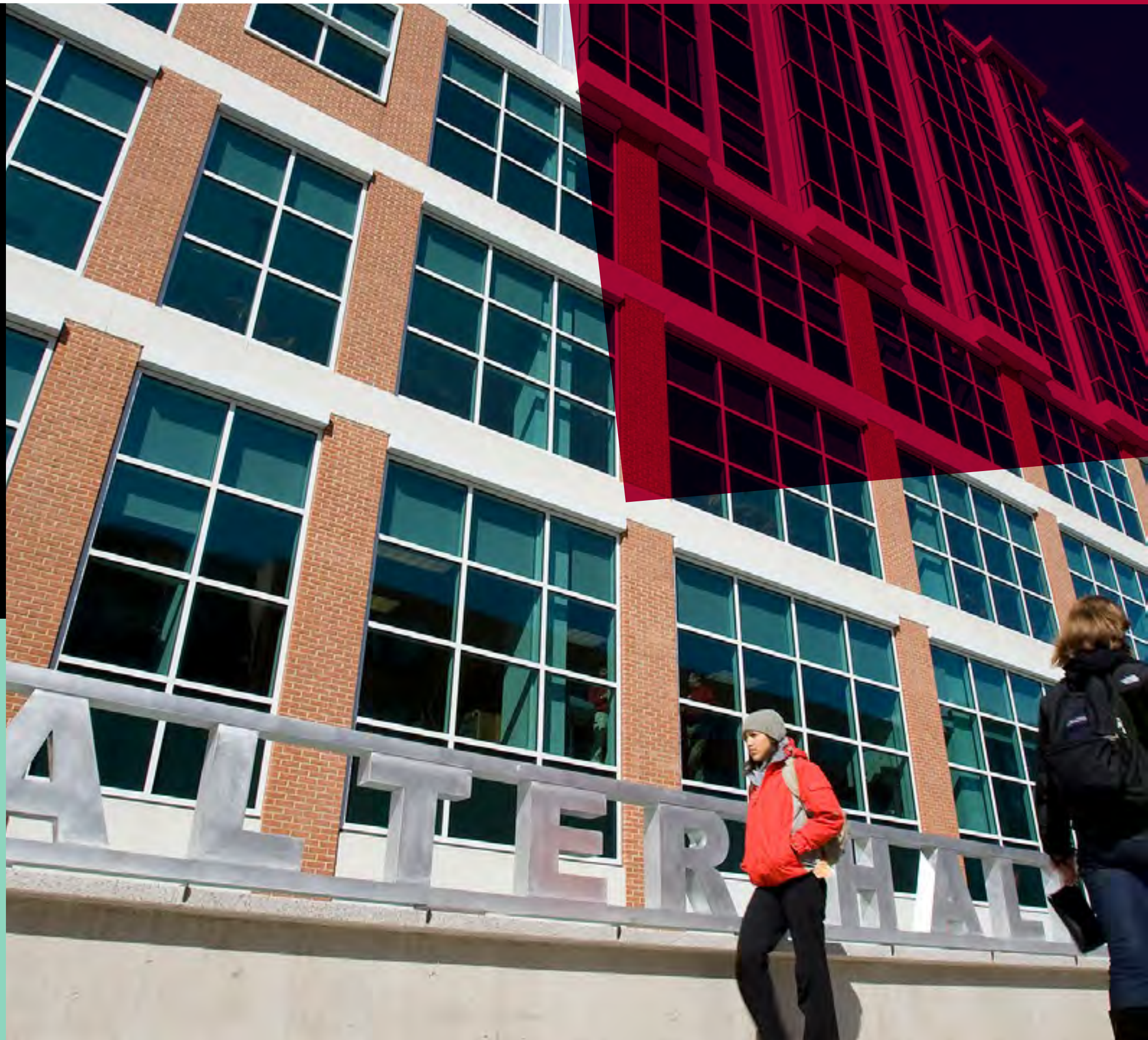





# ACCOUNTING



## **Steven Balsam, PhD**

*Professor; Merves Senior Research Fellow*

Taxation, executive compensation, financial accounting



## **Cory Ng, DBA**

*Assistant Professor; Director of the Undergraduate Accounting Program*

International accounting, international business, accounting education



## **David Jones, DM**

*Associate Professor; Jerome Fox Chair in Accounting, Taxation, and Financial Strategy*

Taxation, real estate, advanced accounting topics



## **Sheri Risler, CPA**

*Assistant Professor; Director of the Master of Accountancy Program*

Accounting, financial statement audits, SEC reporting requirements, accounting education

# FINANCE



**Ronald Anderson, PhD**

*Professor and Department Chair*

Corporate governance, family businesses, executive compensation



**Cynthia Axelrod, CFA**

*Assistant Professor; Director of Financial Planning Programs*

Financial planning, investments, student investment organizations, women in finance



**Bora Ozkan, PhD**

*Assistant Professor*

Undergraduate education, student engagement, financial computer labs



**Jonathan Scott, PhD**

*Professor*

Banking



**Peter Chinloy, PhD**

*Professor; Director of Fox's Real Estate Center*

Real estate



**Philip C. English, PhD**

*Research Assistant Professor*

Investment finance, executive education, experiential learning



**Amir Shoham, PhD**

*Research Associate Professor*

International finance, Israeli relations, online education



**John Soss, PhD, CFA**

*Associate Professor; Academic Director of Specialized Masters in Finance Programs*

Graduate education in finance



# HUMAN RESOURCE MANAGEMENT



**John Deckop, PhD**

*Professor*

Employee motivation, employee satisfaction, pay for performance, ethics



**Deanna Geddes, PhD**

*Associate Professor*

Performance appraisals, workplace aggression, emotional labor, research in hiring and recruitment, organizational response to anger



**Brian Holtz, PhD**

*Associate Professor*

Talent acquisition, hiring



**John McClendon, PhD**

*Associate Professor; Department Chair*

Labor, strategic human resources



**Crystal Harold, PhD**

*Associate Professor; Cigna Research Fellow*

Salary negotiations, employee trust, organizational justice, minorities, fairness and equality issues, talent management



**Arthur Hochner, PhD**

*Associate Professor*

Labor relations, negotiation, union management, collective bargaining processes



**Katherine Nelson**

*Instructor*

Professional competencies, employee engagement, organizational culture, business ethics

# HUMAN RESOURCE MANAGEMENT (cont.)



**In-Sue Oh, PhD**

*Charles E. Beury Professor of Human Resource Management*

Staffing, meta-analysis methods, leadership development



**Ryan Vogel, PhD**

*Assistant Professor*

Employment, leadership

# LEGAL STUDIES IN BUSINESS



**Jeffrey Boles, PhD, JD**

*Associate Professor*

White-collar crime, law and human behavior, ethical judgment, LGBTQIA



**Michael Valenza, JD**

*Associate Professor; Department Chair*

Real estate law, land use policy, employment law, international law



**Leora Eisenstadt, JD**

*Assistant Professor*

Employment law, business law, work-family conflict, sex discrimination, race and the law



**Kevin Fandl, PhD, JD**

*Assistant Professor; Director of International Immersion Programs*

Economic impact of immigration, refugee placement, international business law, public policy





# MANAGEMENT INFORMATION SYSTEMS



**Richard Flanagan**

*Assistant Professor; Director of the MS in IT Auditing & Cybersecurity Program*

Cybersecurity, management of technology



**Amy Lavin**

*Assistant Professor; Director of MS in Digital Innovation in Marketing program*

Digital marketing, e-commerce, information systems education



**Paul Pavlou, PhD**

*Milton F. Stauffer Professor; Senior Associate Dean of Research, Doctoral Programs, and Strategic Initiatives*

Gig economy, social media, e-commerce, information technology outsourcing



**David Schuff, PhD**

*Research Professor; Department Chair*

Technology in politics, data analytics, e-commerce, social media



**Munir Mandviwalla, PhD**

*Associate Professor*

Wireless/cellular systems, social media, information systems design and innovation



**Min-Seok Pang, PhD**

*Assistant Professor*

Technology use by government, financial impacts of government technology use



**Steven Sclarow**

*Assistant Professor of Practice*

Digital design and innovation



**Sunil Wattal, PhD**

*Associate Professor*

Gig economy, security and privacy, e-commerce

# MARKETING & SUPPLY CHAIN MANAGEMENT



**Misty Blessley, PhD**

*Assistant Professor of Instruction*  
Supply chain management



**Mary Conran**

*Associate Professor*  
Retailing, marketing research



**Mark Gershon, PhD**

*Professor*  
Project management, Lean Six Sigma  
process improvement, quality



**Subodha Kumar, PhD**

*Laura H. Carnell Professor of Marketing  
and Supply Chain Management*  
Analytics, social media, healthcare, retailing,  
web and mobile advertising, cybersecurity,  
information technology, supply chain  
management



**Eric Eisenstein, PhD**

*Research Associate Professor*  
Financial decision making, credit  
cards, data analytics, business  
analytics, statistics, general marketing



**Thomas Fung**

*Assistant Professor*  
Consumer packaged goods marketing and  
supply chain, food processing technology, global  
fashion ecosystems, sourcing from China



# MARKETING & SUPPLY CHAIN MANAGEMENT (cont.)



## Xueming Luo, PhD

*Charles E. Gilliland Professor of Marketing*

Mobile customer analytics, machine learning, artificial intelligence, digital marketing, online ads, omnichannel retailing, personalized pricing, competitive targeting, social media networking promotions



## Susan Mudambi, PhD

*Professor; Academic Director of Fox Executive Doctorate in Business Administration Program*

Marketing strategy, international business marketing, digital marketing, customer relationship strategy, supplier relationship strategy, branding, social media, online reviews, B2B marketing, e-commerce, outsourcing, offshoring



## Michael Schirmer, DBA

*Assistant Professor of Practice*

Small businesses, minority-owned businesses, entrepreneurship, online learning



## Jay I. Sinha, PhD

*Associate Professor*

Branding, marketing strategy, consumer psychology, social media marketing



## Edward C. Rosenthal, PhD

*Professor*

Game theory, logistics



## Joydeep Srivastava, PhD

*Robert L. Johnson Professor of Marketing*

Price perceptions, consumer behavior, psychology of money, consumer saving and spending, bargaining and negotiating



## Vinod Venkatraman, PhD

*Assistant Professor; Associate Director of Temple's Center for Neural Decision Making*

Neuroscience in business, neuroscience in marketing, decision-making biases



# RISK, INSURANCE & HEALTHCARE MANAGEMENT



**Benjamin Collier, PhD**

*Assistant Professor*

Severe climate risks, climate change, insurance economics, small business risks, flood insurance, hurricane preparedness, catastrophes, household finances, firm finances



**R.B. Drennan, PhD**

*Associate Professor;  
Department Chair*

Affordable Care Act (ACA), health and welfare employee benefits, healthcare costs, managed care, HMOs, college education



**Martin F. Grace, PhD**

*Harry Cochran Professor of Risk Management*

Tort reform, regulation of insurance, auto insurance pricing, insurance and natural disasters



**Michael Hubbel**

*Associate Professor*

Property-casualty insurance market cycle, excess and surplus lines insurance



**Michael McCloskey**

*Associate Professor*

Personal insurance (home, auto, life, etc.), employee benefits, property and liability insurance, fraud, state licensing, financial literacy





# RISK, INSURANCE & HEALTHCARE MANAGEMENT (cont.)



**Jacqueline Volkman Wise, PhD**

*Assistant Professor*

Behavioral economics and insurance, retirement plans, decision theory, insurance economics



**Jacqueline Zinn, PhD**

*Professor*

Competition, quality and access in the market for nursing home care and home health services



**M. Michael Zuckerman, JD**

*Associate Professor; Academic Director of Fox's Enterprise Risk Management Program*

Risk management, captive insurance, enterprise risk management

# STATISTICAL SCIENCE



**Alexandra Carides, PhD**

*Assistant Professor*

Clinical trials, group sequential, design of experiments



**Eric Eisenstein, PhD**

*Research Associate Professor*

Managerial and consumer decision-making, decision support systems, statistical methods for modeling data



**Alan J. Izenman, PhD**

*Professor*

Theoretical and applied statistics, time-series analysis, multivariate analysis



**Darin Kapanjie, PhD**

*Associate Professor; Academic Director of the Online BBA, Online MBA, and Part-Time MBA programs; Managing Director of Online & Digital Learning*

Online education, instructional technology



# STRATEGIC MANAGEMENT



## Charles Dhanaraj, PhD

*H.F. "Gerry" Lenfest Professor of Strategy; Founding Director of Center for Translational Research in Business; Executive Director of the Executive Doctorate in Business Administration program*

Globalization, international expansion strategy, strategic alliances, emerging markets, multinational enterprises, corporate strategy, nonmarket strategy



## Bertrand Guillotin, DBA

*Assistant Professor; Academic Director of International Business Administration programs*

Globalization, international expansion strategy, higher education, Europe-U.S. relations



## TL Hill, PhD

*Associate Professor; Academic Director of the Global MBA program; Managing Director of the Fox Management Consulting Practice*

Organizational boundaries, community and economic development, family-owned businesses, entrepreneurial networks



## Michael Rivera, PhD

*Associate Professor; Academic Director of the Executive MBA program; Managing Director of the Center for Executive Education*

Human capital analytics, executive education, digital feedback, business model innovation, innovation strategy



## Ram Mudambi, PhD

*Frank Speakman Professor of Strategy*

Technology and innovation management, the geography of innovation, multinational firms, entrepreneurial firms



## Charlotte Ren, PhD

*Associate Professor*

Social entrepreneurship, competitive strategy, innovation



## Todd Schifeling, PhD

*Assistant Professor*

Sustainability, business relationships with government and civil society, innovation, entrepreneurship



## Tony Seeton

*Assistant Professor*

Management consulting, cross-cultural literacy, technology commercialization, career transitions





## Tedi Skiti, PhD

*Research Assistant Professor*

Internet, broadband, competitive policy/strategy



## Jennifer Tae, PhD

*Assistant Professor*

Industry evolution, firm independence



## Ellen Weber

*Assistant Professor; Executive Director of Temple University's Innovation and Entrepreneurship Institute*

Entrepreneurship, venture capital, seed funding, women in entrepreneurship, innovation

